



## Series SMCG150A/SMCG150B

### Subminiature Load Cell



Model SMCG150 (compression only) subminiature load cell is designed to measure load ranges from 150 grams to 1000 pounds with a high frequency response rate. The subminiature dimensions, including diameters from 0.38" to 0.75" and Heights of 0.13" to 0.25" allow these units to be easily incorporated into systems having limited space. A small (1.0" long x 0.08" thick circuit board on ranges 50 g - 1000 g) is included in each load cell's lead wire cable for temperature compensation.

NOTE: Ranges 150G to 1000G lbs only available in SMCG150A style.

SMCG150A

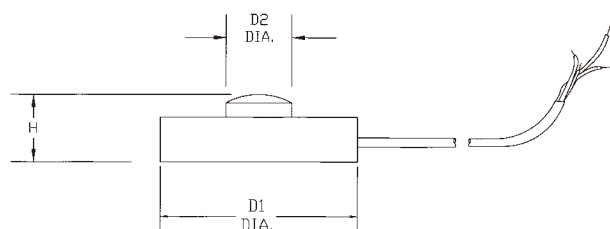

SMCG150B 5 - 50 lbs

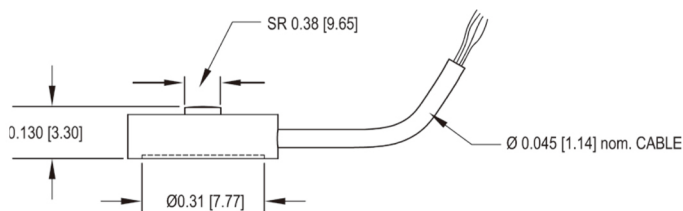

SMCG150B 100 - 250 lbs

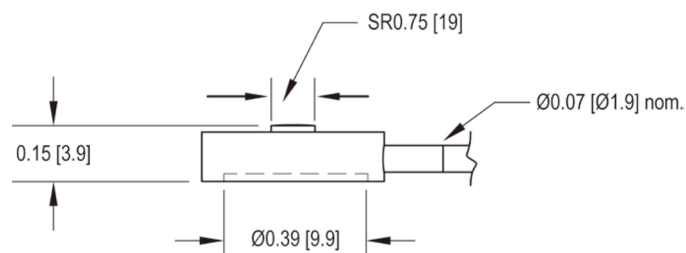

SMCG150B 500 - 1000 lbs

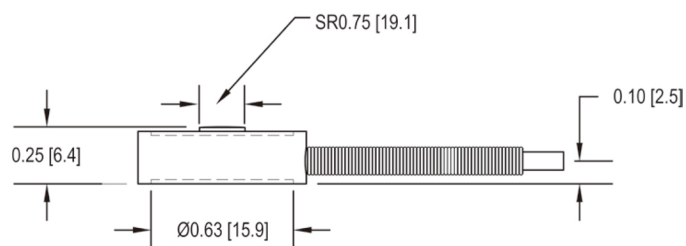

AVAILABLE RANGES	D1"	D2"	H"
150; 250; 500; 1000 g; 5 lb	.38	.09	.13
10; 25; 50 lb	.38	.09	.13
100; 250 lb	.50	.12	.15
500; 1000 lb	.75	.20	.25

- TENSION/COMPRESSION
- WAFER-THIN
- UP TO 1000 LB
- HIGH/LOW TEMP. OPTION
- 150 GMS TO 1000 LB
- OPTIONAL BOTTOM CABLE EXIT

#### CAPACITIES

LB	N
5	22.2
10	44.5
25	111
50	222
100	445
150	667
250	1112
500	2224
1000	4448

## SPECIFICATIONS

LOAD RANGES:	150 g to 1000 lb
LINEARITY/HYSTERESIS:	±0.5% F.S.
REPEATABILITY:	±0.1% F.S.
MATERIAL:	Stainless Steel
TEMPERATURE RANGE:	60° to 160° F
OUTPUT:	150 g to 500 g - 15mv/v 1000 g - 1.5mv/v 5 to 1000 lb - 2mv/v
BRIDGE RESISTANCE:	150 g to 500 g - 500 ohm 1000 g - 350 ohm 5 to 1000 lb - 700 ohm
EXCITATION:	5 Vdc
SAFE OVERLOAD:	50% Over Capacity
CABLE:	
LPM 510A -	4 Conductor Teflon SS Braided Shielded Cable, 5 Ft Long with Temperature Compensation Board on Cable
LPM 510B -	Ranges 5-50: 4 Conductor Teflon SS Braided Shielded Cable, 5 Ft Long Ranges 100 to 250: 4 Conductor Teflon Spiral Shielded Cable, 5 Ft Long
WIRING CODES:	
LPM 510A -	Red +Excitation Black -Excitation Green -Signal White +Signal
LPM 510B -	Red +Excitation Black -Excitation Green +Signal White -Signal

\* Specifications are subject to change without notice

WZO CONTROLS LTD