

Piezoelectric Accelerometer (IEPE)

Model: 1101A3

Features:

- Built-in low noise IEPE
- Low frequency, high sensitivity
- Stable performance

Specifications:

Sensitivity (20±5°C)	500 mV/g±5%
Measurement Range (pk)	100 ms ⁻²
Max Transverse Sensitivity	≤5 %
Frequency Response (±5%)	0.2~ 2,500 Hz
Mounting Resonant Frequency	8,000 Hz
Operating Temp. Range	-40~+120 °C
Temperature Response	See Graph
Shock Limit(pk)	1000 g
Max Output Signal(pk)	≤6 V
Transient Temperature	20 mg/°C(0.3Hz)
Magnetic Sensitivity	0.55 g/T
Base Strain Sensitivity	0.4 mg/με
Noise	<0.08 mg
Output Impedance	<100 Ω
Operating Voltage(Constant current source)	+12~+24 VDC
Operating Current	+2~+10 mA
DC Bias Voltage	7±1 V
Mounting	M5
Sensing Element	Piezoelectric Ceramics
Sensing Geometry	Shear
Case Material	Stainless steel
Weight	100 g
Output	Side L5
Accessories	
Certificate	Calibration parameters, frequency response
M5 Stud, Protection cap	one
L5/ L5 STYV-1(2m)	one

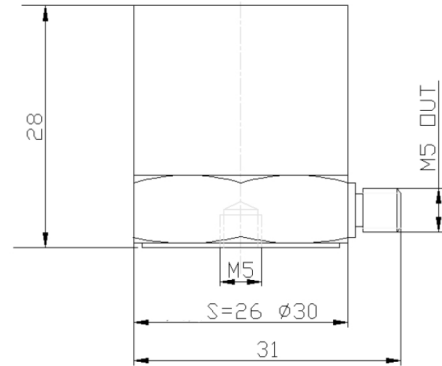

Dimensions

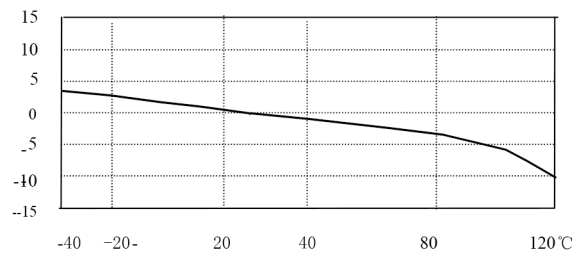

Temperature Response

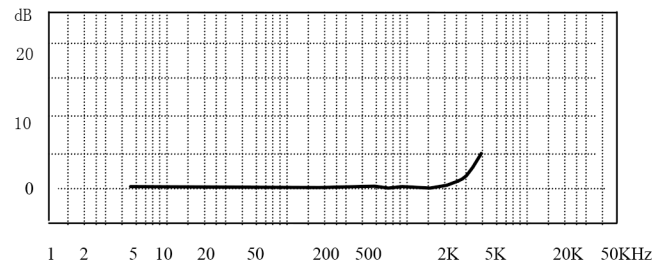

Frequency Response